



L958HEV

SDLG Electric Wheel Loader
19.7 t (43,431 lbs) | 350 kWh

● Highlights

- The L958HEV is equipped with reliable power battery packs, offering strong power, zero emissions, and low noise.
- The dual-motor and four-output transmission system offers smooth shifting and reliable power output.
- Standard high-speed motors with high power density, provide energy-saving and efficiency.
- The smart control system automatically adjusts the power output according to load, speed, and other conditions.
- Integrated regenerative braking technology and auto start and stop, extend the uptime.
- Quick coupler, 3-function valve, emergency steering, and electronic control single handle.
- The intelligent thermal management system can keep all systems safe in extreme environments.
- Loading, Grading, Stacking, and ECO working modes.



Reliability In Action

L958HEV Specifications

Standard bucket capacity
Rated load
Operating weight
Battery type
Battery capacity
Voltage
DC charging capacity
Indicative runtime (depending on application)
Motor type
Rated power
Speed at F1/R1
Speed at F2
Breakout force
Tire size

m ³ (yd ³)	3.2 (4.19)
kg (lbs)	5,800 (12,787)
kg (lbs)	19,700 (43,431)
-	LFP
kWh	350
V	579.6
kW	240
h	5-8
-	PMSM
kw (hp)	231 (310)
km/h (mph)	0~15 (0~9.3)
km/h (mph)	0~40 (0~24.9)
kN (lbf)	150 (33,721)
-	23.5-25

Dimensions

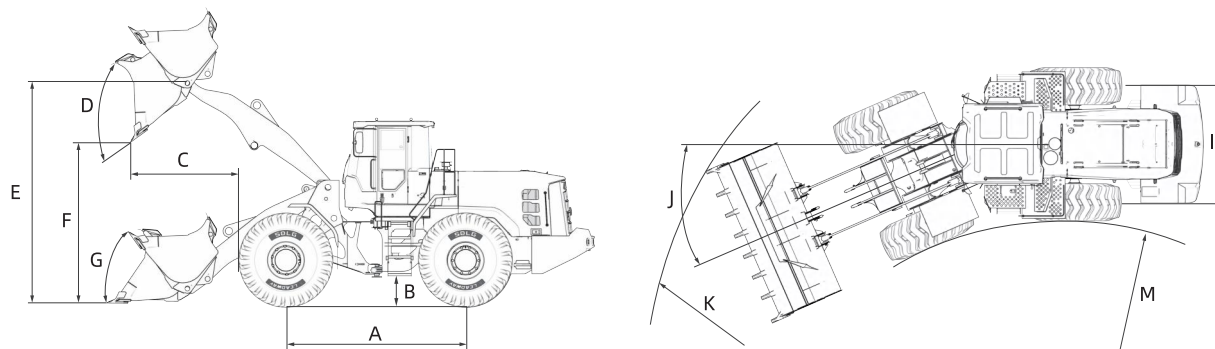

Overall shipping size (L * W * H)	mm (ft in)	8,850 (29' 0.4") * 3,016 (9' 10.7") * 3,460 (11' 4.2")
A Wheelbase	mm (ft in)	3,400 (11' 1.9")
B Ground clearance	mm (ft in)	435 (1' 5.1")
C Reach at max. height	mm (ft in)	1,340 (4' 4.8")
D Dumping angle	°	45
E Height at bucket pin	mm (ft in)	4,145 (13' 7.2")
F Dumping height	mm (ft in)	2,880 (9' 5.4")
G Bucket rollback at ground level	°	42
I Wheel tread	mm (ft in)	2,250 (7' 4.6")
J Articulation angle	°	36
K Turning radius at over bucket	mm (ft in)	7,310 (23' 11.8")
M Turning radius at inside of tires	mm (ft in)	3,788 (12' 5.1")

*SDLG reserves the right to change specifications and materials at any time without prior notification. Features of the machine in photos may include additional equipment. If you need more information and available options, please contact your local distributor or SDLG.



Congratulations SDLG for winning EFQM Global Excellence Award, one of the top three quality awards in the world.

SDLG is a leading international manufacturer of construction machinery, and the national-level high-tech company, with a wide network of dealerships and service workshops throughout the world.

SDLG Europe B.V.

Head Office: Kelvinstraat 4 Harderwijk Netherlands
Website: www.sdlg.com Email: info@sdlgeu.com